

Instruction Sheet

Custom Beam Stand

Column Assembly

Insert column into center of base. Apply a firm downward pressure while twisting the column to assure a tight fit.

Monitor Tray Assembly

Attach the stainless steel tray to the support plate at the top of the column using (4) washers and (4) lock nuts. Firmly tighten all nuts.

Securing Monitor

To secure monitor in place, loosen security bar knobs tray below and move the security bars over the pedestal of the monitor. Tighten by turning the knobs clockwise. After height of stand is set, monitor tray rotation can be dampened by tightening 3 prong knob.

Optional Accessories

Attach to instrument stand as shown using hardware provided.

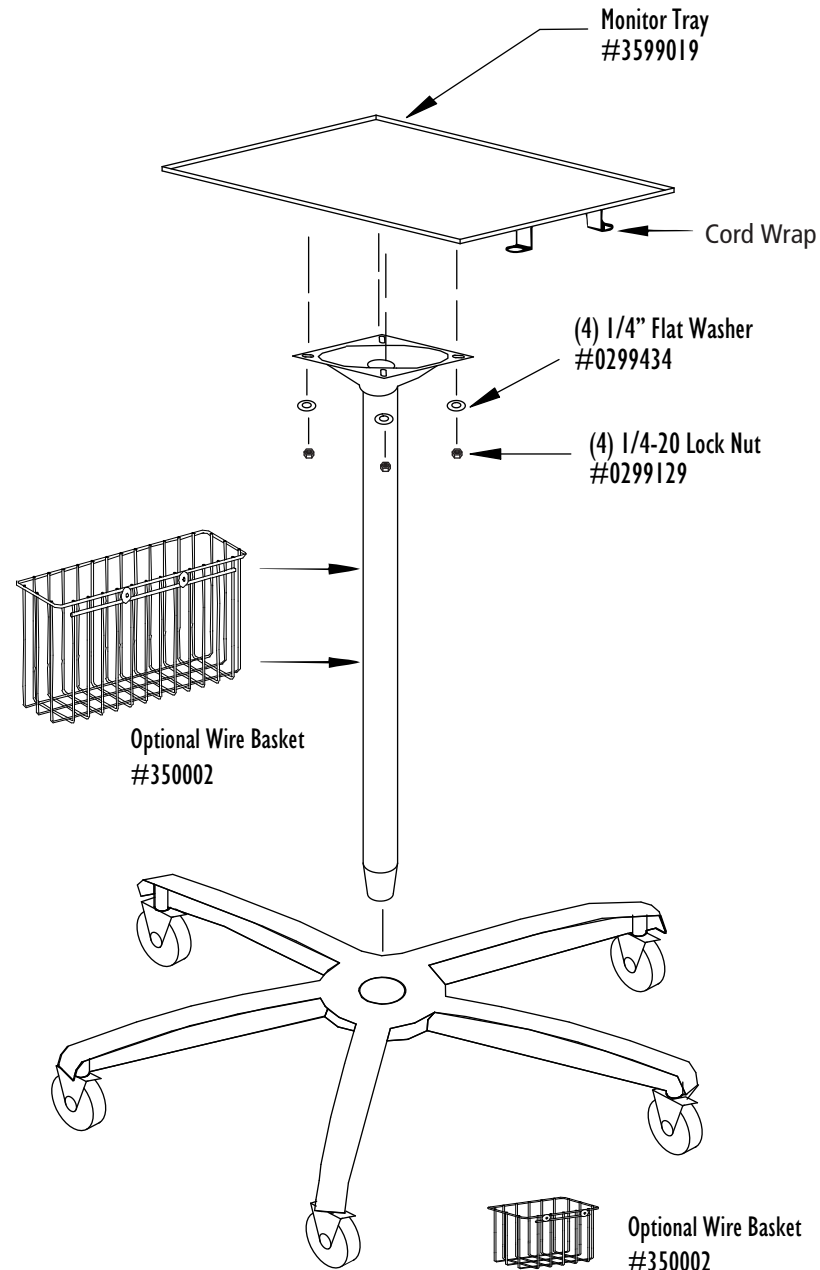

MANUFACTURERS OF **IBeam** PRODUCTS
OMNIMED INC.

800 Glen Avenue • Moorestown, N.J. 08057

800.257.2326 • FAX: 856.359.2249

www.omnimedbeam.com