

Instruction Sheet

JR. Heavyweight Infusion Stand #741301

Pre-Assembly

Remove machine screw, lock washer and large washer from bottom of column.

Column Assembly

Insert column into center of base. Secure from bottom with large flat washer, lock washer and machine screw with the allen wrench provided. Tighten until column is snug with the base.

Hanger Assembly

Rotate hanger insert into the top of the inner column until the hole in the insert lines up with the hole in the inner column. Using the small allen wrench provide, insert into the hole and turn clockwise to tighten.

Hanger Assembly

Rotate hanger insert into the top of the inner column until the hole in the insert lines up with the hole in the inner column. Using the small allen wrench provide, insert into the hole and turn clockwise to tighten.

Mounting Solution Bags/Bottles to Hanger Rods

Loosen locking knob to allow inner column to bottom out. Hang solution bags or bottles onto the larger rods with weight being equally distributed on each side. The maximum weight should not exceed 40 lbs. (one 4000 ml solution bottle weighs approx 8 3/4 lbs.). Raise the inner column to desired height. Turn the locking knob clockwise until hand tight to keep the inner column in the raised position. To lower, turn the locking knob counter-clockwise. The heavy duty IV stand features an air glide system that gradually controls the descent of the inner column whether the solution bags are empty or full.

Check www.omnimedbeam.com for information on Omni Clamping Accessory System that can be used with this stand.

Stand Accessories



Wire Basket
#350005



Transport Basket
#350002

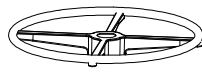

Wheel Ring Handle
#350051



Poly Tray
#350055

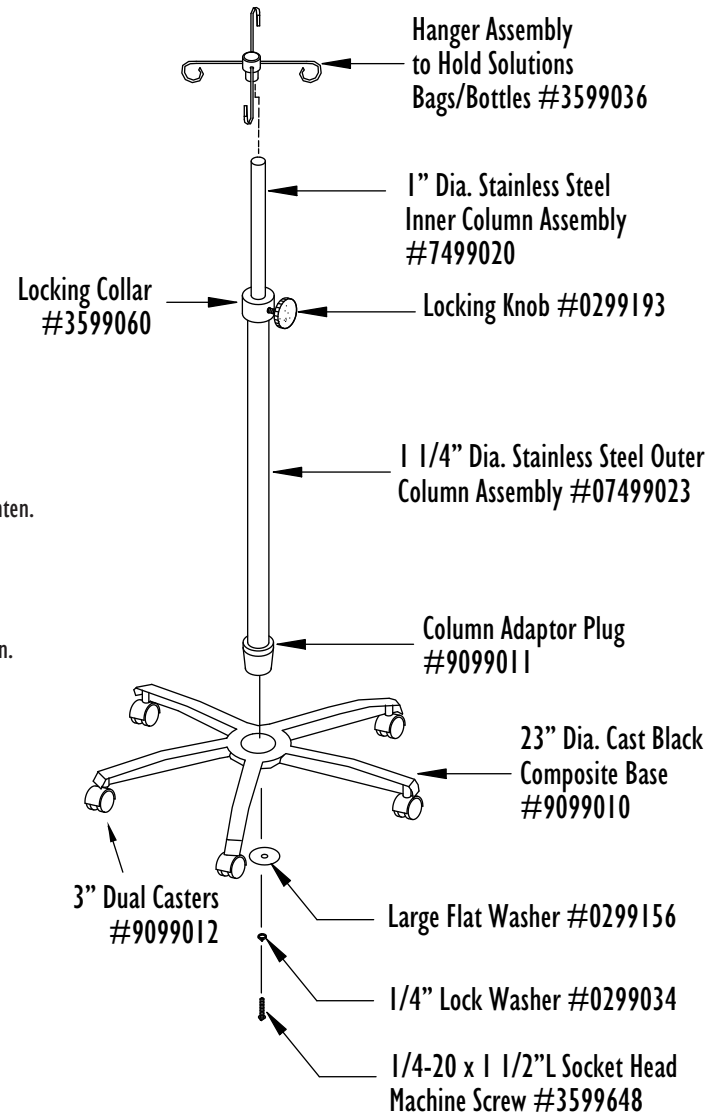

Replacement Parts

Locking Collar Bushing
#7499033

Inner Column Bottom Plug
#7499022

Inner Column Seal
#0299403

Outer Column Plug
#7499025

Outer Column O-Ring Seal
#0299404

MANUFACTURERS OF **IBEAM** PRODUCTS
OMNIMED INC.

800 Glen Avenue • Moorestown, N.J. 08057

800.257.2326 • FAX: 856.359.2249

www.omnimedbeam.com